

# SR-5

## Subminiature time-delay fuses



### Product features

- Radial leaded time-delay thru-hole fuse
- Designed to IEC 60127-3, Sheet 4
- Internationally accepted for primary and secondary overcurrent protection
- Place directly into PCB or plug into BK/PCS holder
- High inrush withstand capability
- Compatible with leaded and lead-free reflow and wave solder

### Agency information

- KC: SU05011-9001 3.15A~6.3A, SU05011-9002 1~2.5A, SU05011-9003 40mA~100mA, SU05011-9004 125mA~800mA
- PSE+JET: JET1641-31007-1001 1~5A, JET1641-31007-1002 6.3A
- CCC: 2009010207370507 40mA~4A
- CQC: CQC09012037502 5A, 6.3A
- SEMKO: 1023113 40mA~6.3A
- cURus: Guide JDYX2, File E306920&E19180 and Guide JDYX8, File E306920&E19180
- VDE: File122052, 40020046

### Environmental data

- Solderability: EIA-186-9E Method 9
- High frequency vibration: MIL-STD-202F, Method 201A
- Operating temperature: -40°C to +125°C
- Soldering heat resistance: 260°C, 10 Sec. max (IEC 60068-2-20)

### Ordering information

- Specify product and packaging code (i.e., SR-5-1A-AP)

| Rated Current | Electrical Characteristics |       |                      |        |                       |       |                    |        |                     |     |
|---------------|----------------------------|-------|----------------------|--------|-----------------------|-------|--------------------|--------|---------------------|-----|
|               | 1.5 x I <sub>n</sub>       |       | 2.1 x I <sub>n</sub> |        | 2.75 x I <sub>n</sub> |       | 4 x I <sub>n</sub> |        | 10 x I <sub>n</sub> |     |
|               | min                        | max   | min                  | max    | min                   | max   | min                | max    | min                 | max |
| 100mA-6.3A    | 1 hr                       | 2 min | 400 mS               | 10 Sec | 150 mS                | 3 Sec | 20 mS              | 150 mS |                     |     |

| Part Number | Voltage Rating AC | Interrupting Rating (amps) @ Rated Voltage | Typical DC Cold Resistance (Ω) | Typical Melting** I <sup>2</sup> t (@1mS) | Voltage Drop mV @ 20°C Rated Current | Agency Information |       |       |      |          |       |
|-------------|-------------------|--|--------------------------------|---|--------------------------------------|--------------------|-------|-------|------|----------|-------|
|             |                   |  |                                |   |                                      | VDE                | SEMKO | cURus | CCC  | KC-Mark  | PSE   |
|             |                   |  |                                |   |                                      | SR-5-100mA         | 250   | 35    | 2.37 | 0.015155 | 288.5 |
| SR-5-125mA  | 250               | 35   | 1.6                            | 0.026783                                  | 238                                  | x                  | x     | x     | x    | x        |       |
| SR-5-160mA  | 250               | 35   | 1.02                           | 0.039097                                  | 196.5                                | x                  | x     | x     | x    | x        |       |
| SR-5-200mA  | 250               | 35   | 0.94                           | 0.168832                                  | 215.5                                | x                  | x     | x     | x    | x        |       |
| SR-5-250mA  | 250               | 35   | 0.66                           | 0.24778                                   | 185                                  | x                  | x     | x     | x    | x        |       |
| SR-5-315mA  | 250               | 35   | 0.43                           | 0.2772                                    | 152                                  | x                  | x     | x     | x    | x        |       |
| SR-5-400mA  | 250               | 35   | 0.285                          | 0.771618                                  | 127                                  | x                  | x     | x     | x    | x        |       |
| SR-5-500mA  | 250               | 35   | 0.242                          | 2   | 143.5                                | x                  | x     | x     | x    | x        |       |
| SR-5-630mA  | 250               | 35   | 0.154                          | 3.5                                       | 113                                  | x                  | x     | x     | x    | x        |       |
| SR-5-800mA  | 250               | 35   | 0.112                          | 6.5                                       | 104.5                                | x                  | x     | x     | x    | x        |       |
| SR-5-1A     | 250               | 35   | 0.085                          | 7.5                                       | 100                                  | x                  | x     | x     | x    | x        | x     |
| SR-5-1.25A  | 250               | 35   | 0.061                          | 13  | 91                                   | x                  | x     | x     | x    | x        | x     |
| SR-5-1.6A   | 250               | 35   | 0.043                          | 24  | 102                                  | x                  | x     | x     | x    | x        | x     |
| SR-5-2A     | 250               | 35   | 0.031                          | 30  | 74.5                                 | x                  | x     | x     | x    | x        | x     |
| SR-5-2.5A   | 250               | 35   | 0.024                          | 45  | 72.5                                 | x                  | x     | x     | x    | x        | x     |
| SR-5-3.15A  | 250               | 35   | 0.018                          | 57  | 70.25                                | x                  | x     | x     | x    | x        | x     |
| SR-5-4A     | 250               | 40   | 0.012                          | 80  | 62                                   | x                  | x     | x     | x    | x        | x     |
| *SR-5-5A    | 250               | 50   | 0.010                          | 95.4                                      | 57.5                                 | x                  | x     | x     | CQC  | x        | x     |
| *SR-5-6.3A  | 250               | 63   | 0.008                          | 200                                       | 60.85                                | x                  | x     | x     | CQC  | x        | x     |

\* Conducting Path min. 0.2mm<sup>2</sup>

\*\* I<sup>2</sup>t value for 100mA to 400mA is measured at 100In. I<sup>2</sup>t value for 500mA to 6.3A is measured at 10In.

Time-Current Curves

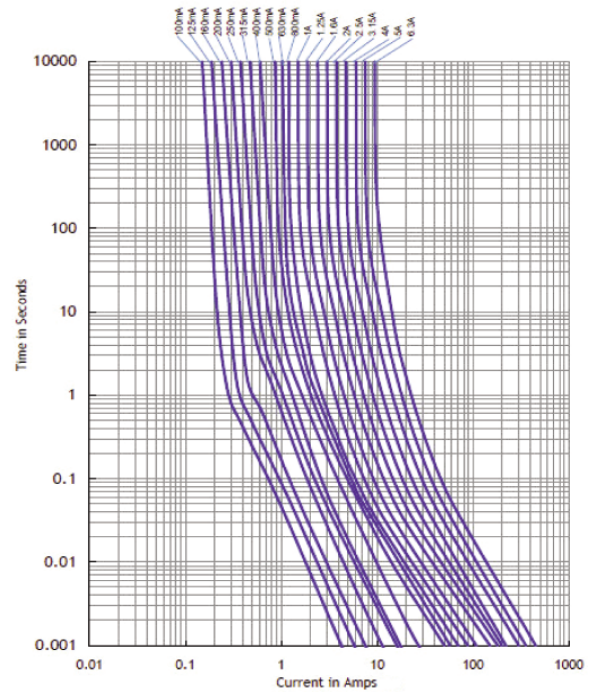

Dimensions – mm

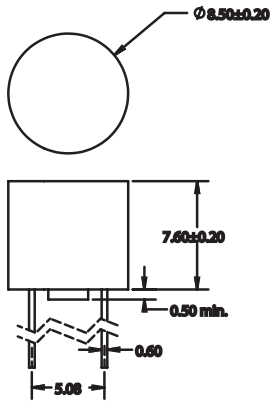

Land Pattern

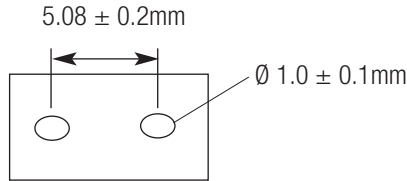

Packaging Information – mm

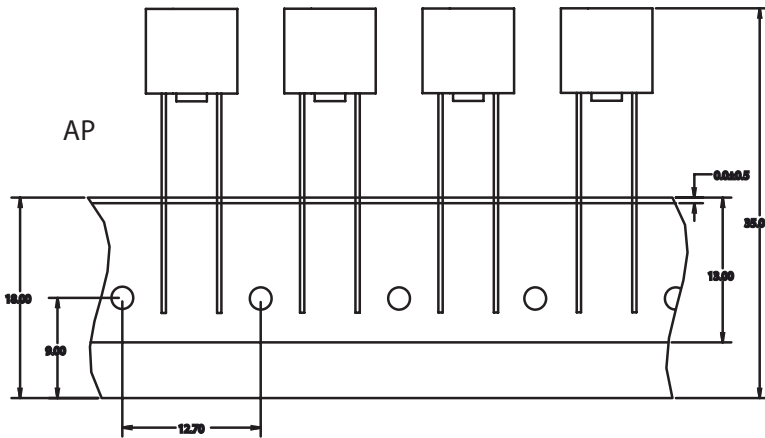

PCS Mounting Socket (RoHS compliant)- mm [in]

- Available as option. Specify catalog number BK/PCS (in bulk 100 per bag)

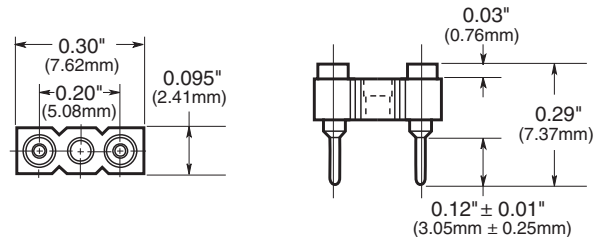

| Packaging Code        |  |
|-----------------------|--|
| Packaging Code Suffix | Description  |
| -AP                   | Ammo-pack taped 1000 per box (see Packaging Information for lead configurations) |
| -BK, -BK2             | In bulk 200 per bag (see Packaging Information for lead configurations)          |

Life Support Policy: Eaton does not authorize the use of any of its products for use in life support devices or systems without the express written approval of an officer of the Company. Life support systems are devices which support or sustain life, and whose failure to perform, when properly used in accordance with instructions for use provided in the labeling, can be reasonably expected to result in significant injury to the user.

Eaton reserves the right, without notice, to change design or construction of any products and to discontinue or limit distribution of any products. Eaton also reserves the right to change or update, without notice, any technical information contained in this bulletin.

**Eaton**  
**Electronics Division**  
 1000 Eaton Boulevard  
 Cleveland, OH 44122  
 United States  
[www.eaton.com/electronics](http://www.eaton.com/electronics)

© 2017 Eaton  
 All Rights Reserved  
 Printed in USA  
 Publication No. 4347 BU-SB11806  
 June 2017

# Mouser Electronics

Authorized Distributor

Click to View Pricing, Inventory, Delivery & Lifecycle Information:

## Eaton:

[SR-5-5A-BK](#) [SR-5-5A-AP](#) [SR-5-630MA-AP](#) [SR-5-800MA-AP](#) [SR-5-400MA-AP](#) [SR-5-500MA-AP](#) [SR-5-500MA-BK](#)  
[SR-5-630MA-BK](#) [SR-5-800MA-BK](#) [SR-5-3.15A-BK](#) [SR-5-3.15A-AP](#) [SR-5-4A-BK](#) [SR-5-4A-AP](#) [SR-5-2A-BK](#) [SR-5-2A-AP](#) [SR-5-1A-AP](#) [SR-5-1A-BK](#) [SR-5-1.6A-BK](#) [SR-5-1.6A-AP](#) [SR-5-2.5A-AP](#) [SR-5-2.5A-BK](#) [SR-5-1.25A-BK](#) [SR-5-1.25A-AP](#) [SR-5-6-3A-AP](#) [SR-5-6-3A-BK](#) [SR-5-100MA-AP](#) [SR-5-100MA-BK](#) [SR-5-125MA-AP](#) [SR-5-125MA-BK](#) [SR-5-160MA-AP](#) [SR-5-160MA-BK](#) [SR-5-200MA-AP](#) [SR-5-200MA-BK](#) [SR-5-250MA-AP](#) [SR-5-250MA-BK](#) [SR-5-315MA-AP](#) [SR-5-315MA-BK](#) [SR-5-40MA-AP](#) [SR-5-40MA-BK](#) [SR-5-50MA-AP](#) [SR-5-50MA-BK](#) [SR-5-63MA-AP](#) [SR-5-63MA-BK](#) [SR-5-80MA-AP](#) [SR-5-6.3A-AP](#) [SR-5-6.3A-BK](#)